

FOR SALE

21 PREMIUM LOTS

John's Landing – GREAT VIEWS (VPT 1/2)

- 3.8 acres, 21 legal lots, c. 4,500-6,000 sq ft each
- Stunning views of Mt Hood and Willamette River
- <5 min drive to Downtown, 5 min walk to River
- Permit-ready for infrastructure/improvements – ready to build out Summer 2019
- Full/approved civil/engineering drawings
- No further land use reviews/approvals
- House design created (3,033 sqft living space)
- Project name: VPT1/2



For information:

Simon Lofts
Sustainable Infill Development
971-300-6562

simonfromsid@gmail.com
www.sustainableinfilldevelopment.com

VPT1/2 Lots in relation to other parcels for sale (VPT3 and VPT4)

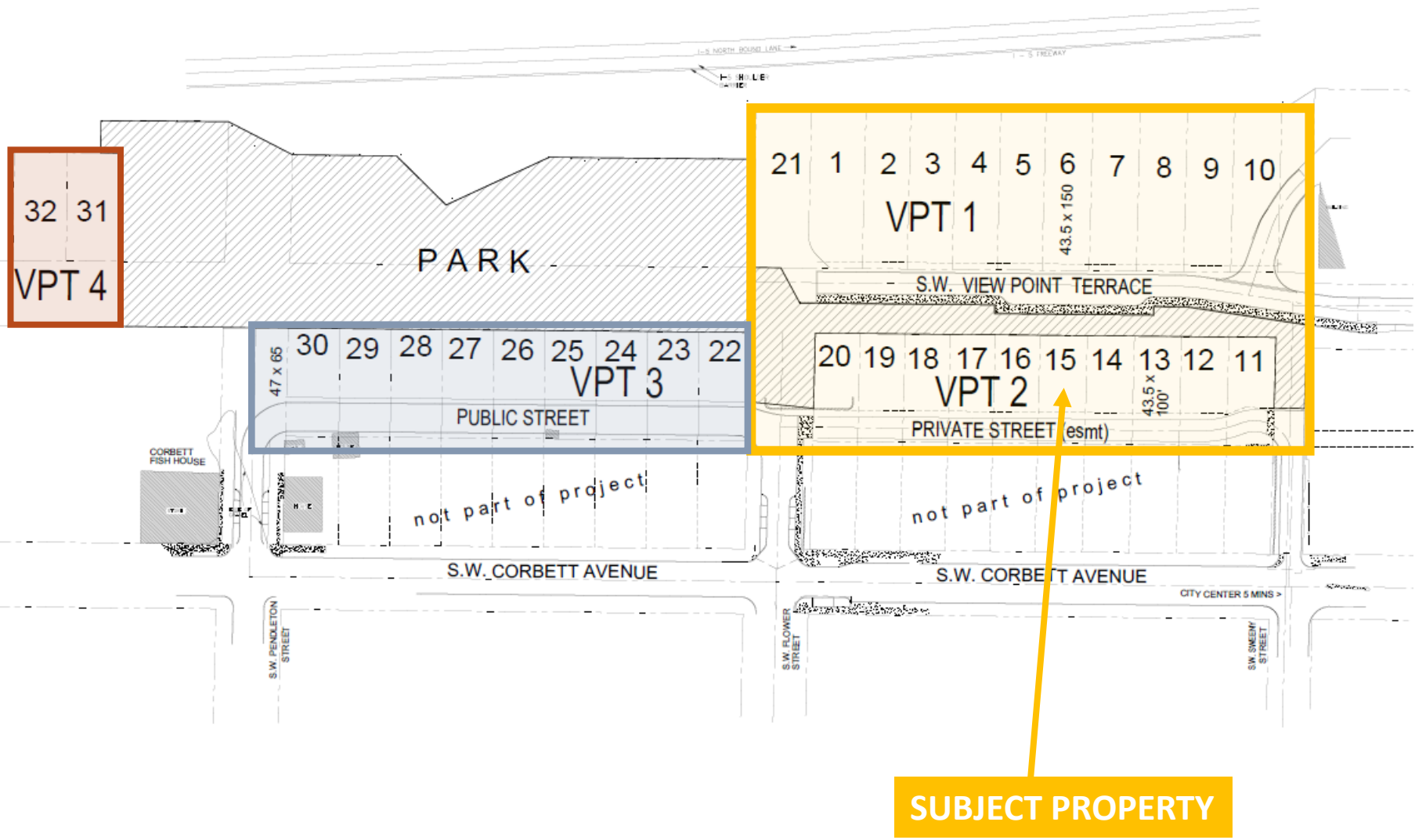

VPT 1/2 civil plans/public improvements

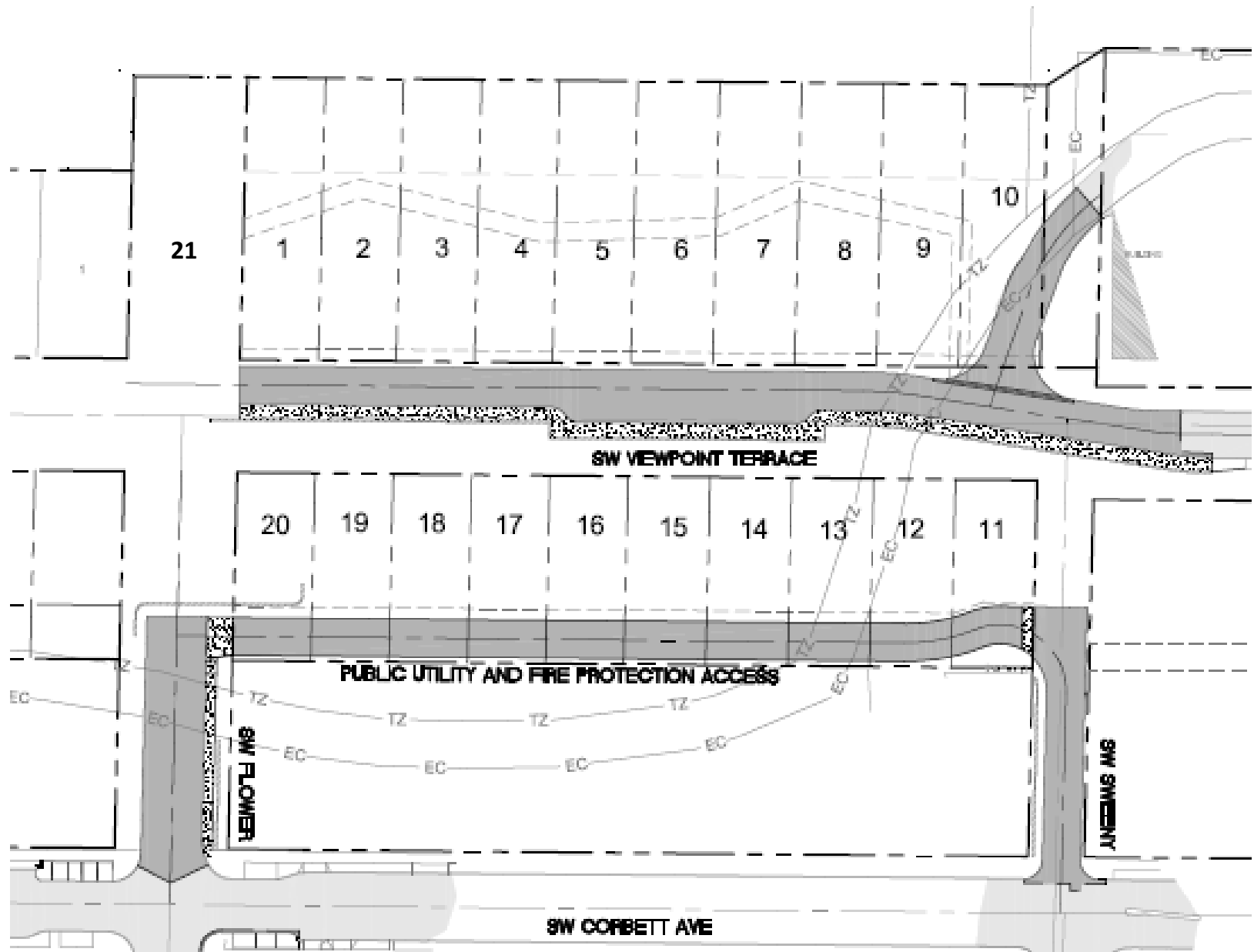

House Design for VPT1/2 Lots

